



Fisheye Cameras

Amazing Megapixel video that delivers detail from every angle

Part of IndigoVision's professional BX Range, the Fisheye Camera delivers 360° visibility with pinsharp detail. When used as part of IndigoVision's end-to-end system, any single point of failure is removed through IndigoVision's Distributed Network Architecture (DNA) technology.

Key Features

SENSOR

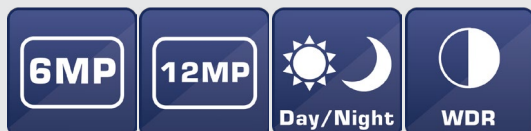

COMPRESSION

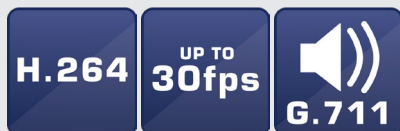

INTELLIGENCE



OTHER



PHYSICAL



Product Codes

BX720 Fisheye Cameras	Product Code
6MP Fisheye Camera with Built-In IR Illuminator	612740
12MP Fisheye Camera with Built-In IR Illuminator	614740

Dimensions

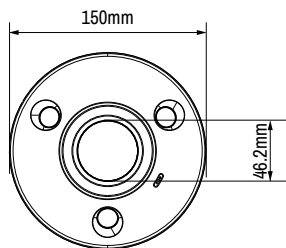

View on Top Face

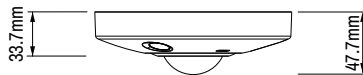

View on Side Face

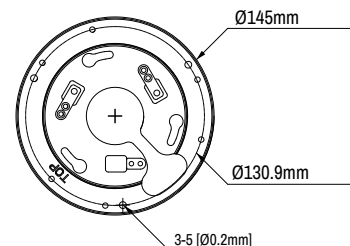

Mounting Hole Pattern

Specification

Camera Features	6MP	12MP
Sensor	1/1.8" Progressive CMOS	1/1.7" Progressive CMOS
Active Pixels (HxV)	6MP (3072x2048)	12MP (4000x3000)
Minimum Sensitivity	Day: 0.02 lux (colour). Night: 0 lux (mono). 30 IRE, F2.0, 1/30s shutter	Day: 0.01 lux (colour). Night: 0 lux (mono). 30 IRE, F2.8, 1/30s shutter
Dynamic Range	WDR 100dB Max	
Gain Control	Auto/Manual	
Back Light Compensation	On/Off	
White Balance Mode	Auto, Natural, Streetlamp, Outdoor, Manual, Regional Custom	
Day/Night	True Day/Night with Mechanical IR Cut Filter	
IR Illuminator	Built-in IR Illuminator 850nm wavelength, effective distance >10m	
Video Resolution	3072x2048 (6MP) 2048x2048 (4MP) 1600x1200 (2MP) 2048x1536 (3MP) 1280x720 (720P) 704x576 (D1) 704x480 (D1) 352x288 (SIF) 352x240 (SIF)	4000x3000 (12MP) 2880x2880 (8MP) 2880x2160 (6MP) 2048x1536 (3MP) 1280x720 (720P) 704x576 (D1) 704x480 (D1) 352x288 (SIF) 352x240 (SIF)
Signal/Noise Level	> 50dB	
Lens Options	1.7mm, Horizontal view angle 180°x180°, F2.0, Fixed Iris	1.98mm, Horizontal view angle 180°x180°, F2.8, Fixed Iris
Shutter	Rolling; Auto from 1/3 - 1/100,000 sec	
Exposure Control	Auto / Gain Priority / Shutter Priority / Manual	
Video Compression	Full frame rate, full colour: H.264/MJPEG ; up to 30fps	
Video Bit Rate	User-configurable bit rates from 3Kbps up to 16834Kbps are selectable	
Privacy Zones	4 User Defined	
Video Multi-Streaming	Up to 32Mbps total video output; Unlimited multicast connections. Up to two 16Mbps unicast connections; Up to four 8Mbps unicast connections; Up to sixteen 1Mbps unicast connection	
Video Multi-Encoder	Edge Dewarping: Dual Streaming 3MP (2048 x 1536) @ 30fps + D1/SIF @ 30fps Native: Dual Streaming 12MP (4000x3000)* @ 25fps + D1/SIF @ 30fps or 3MP 2048x1536 pixels + or 6MP (3072 x 2048) @ 30fps + 720P @ 30fps	
Video Analytics	Motion Detection, Tripwire, Intrusion, Video Tamper, Scene change, Audio	
Intelligence	Heat Map	
Audio Compression	G.711Mu / AAC	
Audio Bit Rate	16-96Kbps per channel	
Audio Dual Encoder	Main Stream: 1 Stream Configuration plus Sub Stream: 1 Stream Configuration	
Audio Resolution	Full Duplex, G.711Mu 8 KHz sample rate, AAC is configurable with options 8, 16, 32 and 48 KH, Mono Input, Mono Output	
Audio Analytics	Audio Input Abnormal, Audio Intensity High	
Audio Input	Built-in microphone or Line in, RCA connector	
Audio Output	Line out, RCA connector	
Binary Input/Output	2 Pull up inputs for non powered contacts; 2 relay outputs, 30VDC 1A/ 50VAC 0.5A	
Network Interface	EEE802.3 and IETF standards: 100/1000 Base-T Ethernet, IPv4/IPv6, TCP, UDP, RTP, RTSP, ICMP, IGMP, SNMP, HTTP, HTTPS, PPPoE, uPnP, QoS, DHCP	
Network Security	HTTPS, IP Filter, IEEE 802.1x	
CyberVigilant® Technology	Yes	
Time	Embedded real-time clock, NTP client	
SD Storage	microSDHC 128GB support (card not included)**	
Dimension/Weight	150mm (dia) x 47.7mm (h) and 0.58Kg	
Regulatory	EN 55032, EN 61000-3-2, EN 61000-3-3, FCC Part 15 Subpart B Class A, EN 50130-4, EN 60068-2-29, EN 60068-2-6, EN 60068-2-64, EN 60068-2-1, EN 60068-2-2, EN 60068-2-30, UL, EN 60529, EN 62262	
Housing	White vandal resistant aluminium alloy including 500mm cable bundle	
Protection Rating	P67, IK10	
Electrical	PoE (802.3af Class 0) or 12V DC @ 1.1A; 13W Power supply ordered separately (Product code: 110068; 130176)	
Operating Temperature	-30°C to 60°C	
Cold Start	-30°C	
IndigoVision Software Requirements	Control Center v15.4 or later	
Supported Internet Browsers	Internet Explorer v11.0 or later	
ONVIF	Profile S	

**SDCard Storage independent of IndigoVision's NVRs.